



# EXPLODED VIEW PARTS AND PRICE LIST

MODEL 357 357BB  
PHASE III

CROSMAN CORPORATION  
RT 5 & 20  
EAST BLOOMFIELD, NY 14443

Phone: 1-800-724-7486  
Parts Order Fax: 585-657-5405

C357EVP3 C357BBEVP3

REV	1
DATE	

# MODEL NO. 3576W, 3574W, 3576BB

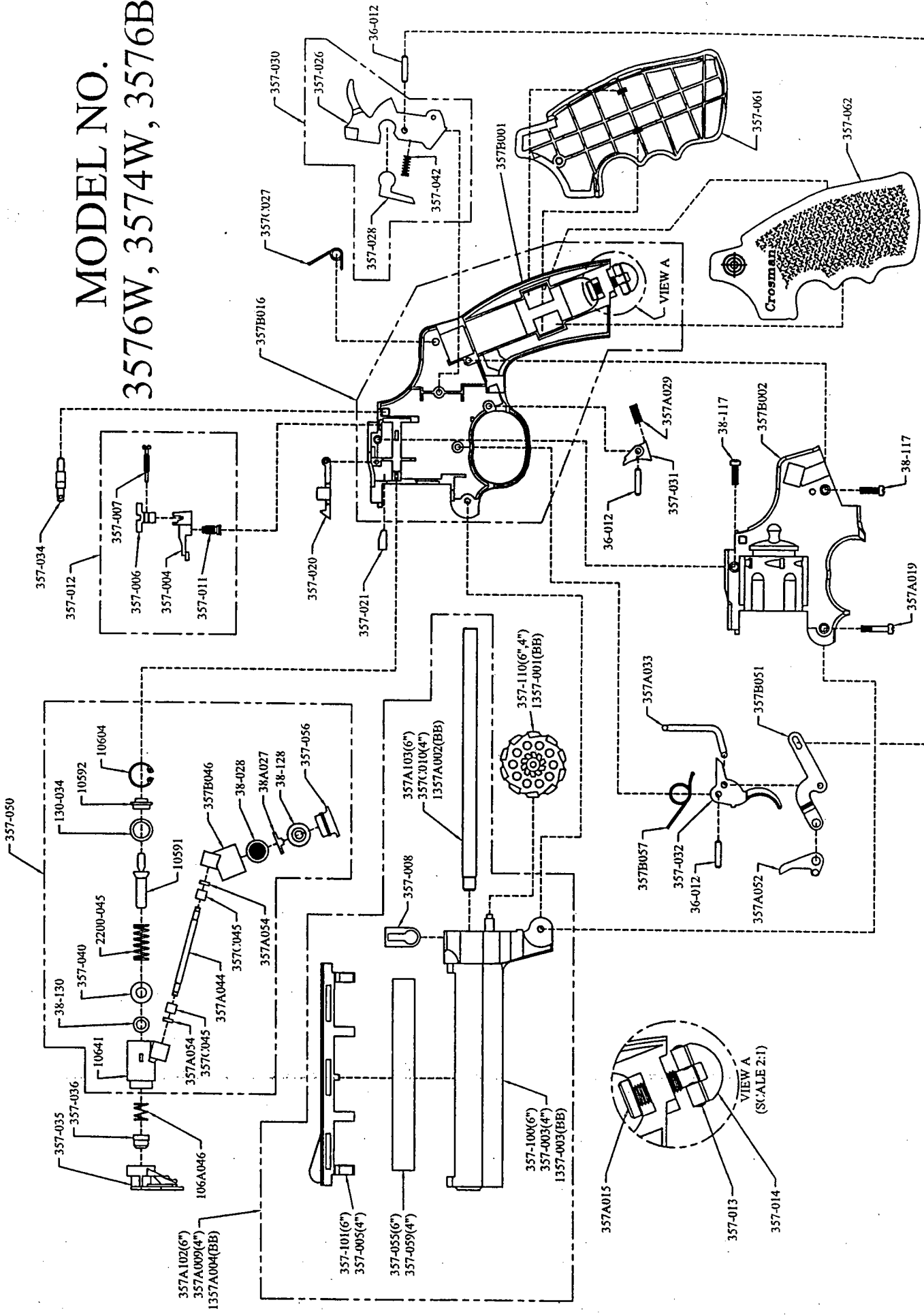

- 357-034
- 357-012
- 357-007
- 357-006
- 357-004
- 357-011
- 357-020
- 357-021
- 357B016
- 357C027
- 357-028
- 357-042
- 357B001
- 357-030
- 357-026
- 36-012
- 357A029
- 38-117
- 357B002
- 38-117
- 357A019
- 357-034
- 130-034
- 10592
- 10604
- 357B046
- 38-028
- 38A027
- 38-128
- 357-056
- 357A054
- 357C045
- 357A044
- 357A054
- 357A033
- 357B057
- 357-032
- 36-012
- 357A052
- 357B051
- 357A015
- 357-013
- 357-014
- 357A103(6")
- 357C010(4")
- 1357A002(BB)
- 357-101(6")
- 357-005(4")
- 357-055(6")
- 357-059(4")
- 357-100K(6")
- 357-003(4")
- 1357-003(BB)
- 357-110(6" 4")
- 1357-001(BB)
- VIEW A
- VIEW A (SCALE 2:1)
- Crosman

MODEL 3574 3576 357 BB  
PARTS AND PRICE LIST  
PHASE III  
START MANUFACTURE MARCH 2000

<u>PART NUMBER</u>	<u>QTY PER</u>	<u>PART NAME</u>	<u>COST</u>
10591	1	VALVE STEM	\$1.63
10592	1	PUCK ASSY	\$1.00
10604	1	RETAINING RING	\$1.00
10641	1	VALVE BODY	\$1.39
106A046	1	SPRING	\$1.00
130-034	1	O RING	\$1.00
2200-045	1	SPRING	\$1.00
357-026	1	HAMMER	\$1.64
357-003	1	BARREL HOUSING	\$2.28
357-004	1	SIGHT BASE	\$1.00
357-005	1	HOUSING RIB	\$1.26
357-006	1	SIGHT BLADE	\$1.00
357-007	1	SCREW	\$1.00
357-008	1	PLATE	\$1.00
357-011	1	SCREW	\$1.00
357-012	1	R.SIGHT ASSY	\$2.03
357-013	1	PIN	\$1.00
357-014	1	LEVER	\$1.00
357-020	1	LATCH	\$1.00
357-021	1	SPRING	\$1.00
357-028	1	PAWL	\$1.00
357-030	1	HAMMER ASSY	\$2.12
357-031	1	SEAR	\$1.00
357-032	1	TRIGGER	\$1.00
357-034	1	SAFETY	\$1.00
357-035	1	CYLINDER PLATE	\$1.00
357-036	1	DETENT	\$1.00
357-040	1	WASHER	\$1.00
357-042	1	SPRING	\$1.00
357-050	1	VALVE ASSY	\$14.84
357-055	1	BARREL WEIGHT	\$1.00
357-056	1	GUIDE COLLAR	\$1.00
357-059	1	BARREL WEIGHT	\$1.00
357-061	1	GRIP R.H.	\$1.15
357-062	1	GRIP L. H.	\$1.15
357-100	1	BARREL HOUSING	\$2.86
357-101	1	HOUSING RIB	\$1.44
357A103	1	BARREL	\$2.05
357-110	1	CYLINDER 10 SHOT	\$1.00
357A009	1	HOUSING ASSY	\$6.06
357C010	1	BARREL	\$1.59
357A015	1	SCREW	\$1.00
357A019	1	SCREW	\$1.00

MODEL 3574 3576 357 BB  
PARTS AND PRICE LIST  
PHASE III  
START MANUFACTURE MARCH 2000

<u>PART NUMBER</u>	<u>QTY PER</u>	<u>PART NAME</u>	<u>COST</u>	
357A029	1	SPRING	\$1.00	
357A033	1	LINK	\$1.00	
357A044	1	TUBE	\$1.00	
357A051	1	LINK (use 357B051)	*	
357B051	1	LINK	\$1.00	
357A052	1	INDEX FINGER	*	
357A054	2	SEAL	\$1.00	each
357A057	1	TRIGGER SPRING (use 357B057)	*	
357B057	1	TRIGGER SPRING	\$1.00	
357A102	1	BARREL HSG ASSY	\$7.38	
357B001	1	FRAME	\$7.30	
357B002	1	COVER	\$3.81	
357B016	1	FRAME ASSY	\$9.15	
357B046	1	P. BLOCK	\$1.73	
357C027	1	HAMMER SPRING	\$1.00	
357C045	2	O RING RETAINER	\$1.00	each
36-012	3	PIN	\$1.00	each
38-028	1	SCREEN	\$1.00	
38-117	2	SCREW	\$1.00	each
38-128	1	END SEAL	\$1.00	
38-130	1	O RING	\$1.00	
38A027	1	PIN	\$1.00	
1357-001	1	B.B. CYLINDER	\$2.31	not shown
1357A002	1	B.B. BARREL 6"	\$1.64	not shown
1357-003	1	B B BARREL HSG.	\$3.18	not shown
1357A004	1	B B BARREL HSG. ASSY	\$8.02	not shown

**THIS PARTS AND PRICE LIST IS INTENDED TO BE AN INFORMATIONAL GUIDE IN ORDERING CROSMAN PARTS. IT IS NOT INSTRUCTIONAL MATERIAL AN WE THEREFORE ASSUME NO RESPONSIBILITY FOR THOSE WHO USE SAME WITHOUT PROPER FACTORY TRAINING.**

**PRICES AND PARTS ARE SUBJECT TO CHANGE WITHOUT NOTICE**

**PLEASE ORDER BY PART NUMBER AND DESCRIPTION**

**CHECK OR MONEY ORDER FOR THE TOTAL PRICE MUST ACCOMPANY THE ORDER**

**\* NOT AVAILABLE**

UPDATED 10/01